



ION® SERIES

unios®

Unios Toolbox

This digital tool provides you with a platform for configuring, bookmarking and collaborating on luminaires for any project.

unios.com/toolbox

LX Configurator

Create a tailor-made linear design in minutes with the pioneering digital tool. With 24/7 access to customised shapes, specifications, IES, BIM and Revit files, there is no limitation to creativity.

unios.com/lxconfigurator

Catalogues

Stay up to date with the latest Unios luminaire releases with our range of product catalogues.

unios.com/catalogues

Education

With contributions from leading experts, Universal Light is dedicated to increasing the awareness of the impact of light and the lighting industry.

unios.com/universallight

White Papers

Learn about the specifics of new technologies and trending topics in methodically researched white papers.

unios.com/whitepapers

Changing how the
world views lighting

Building digital tools.
Sharing new knowledge.



**One series.
Infinite possibilities.**

Reimagining the downlight experience

In search of a universal downlight range that balances form, function and performance, the ION R Series is the culmination of our years researching to understand our supporters' needs. At every stage of its becoming, this series was purposefully engineered to make lighting easier for everyone, from our specifiers and contractors to end-users.

Universal

With 6 models, 4 sizes, extensive accessories and a wide output range, the ION R Series is designed to become the one-stop range that meets all your downlighting needs in a project, whether that be commercial or residential.

Form & Function

Equipped with various accessories and finishes, including a range of primary and secondary optics and a new Stealth Metallic baffle option, the ION R can be configured to meet any space's aesthetic requirements.

Performance-focused

Built with an engine that prevents overheating at high output and lens technology for greater beam control capabilities, the ION R Series promises high performance that will last for years.

Crafted in Australia

Over 80% of the ION R's configurable options will be stocked and assembled from our local facilities in Australia, delivering high-quality products at a shorter lead time.

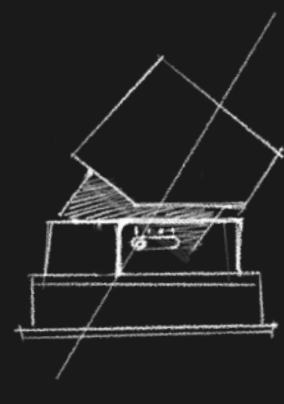
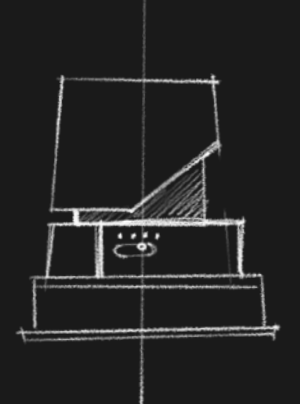
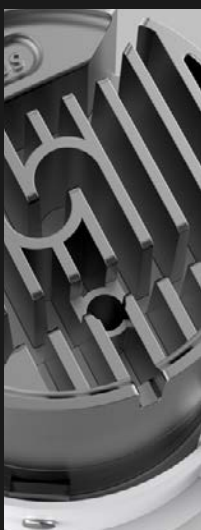
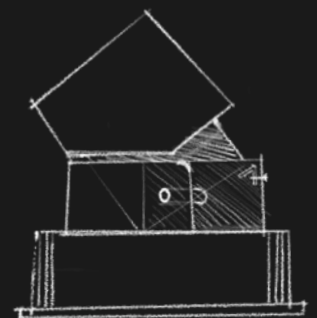

The ION R Series: An overview

2 engines. 4 sizes. 6 models. 26,000+ customisations. The possibilities are endless with the ION R Series.

Refer to the table on the right for an overview of the ION R Series models.

Find the complete specifications and configure the exact model on Unios Toolbox.

| |  |  |  |  |  |  |
|---------------------------------------|---|---|---|---|---|---|
| | ION R Downlight | ION R Wallwasher | ION R Vandal Proof Downlight | ION R Adjustable Downlight | ION R Focus Downlight | ION R Accent Downlight |
| Types | Small, Medium, Large, XL | Medium, Large | Large | Small, Medium, Large | Small | Small |
| Power (Up to) | 11W, 15W, 32W, 43W | 15W, 32W | 32W | 7W, 13W, 29W | 7W | 7W |
| Mounting | Recessed, Surface Mounted, Suspended | Recessed, Surface Mounted, Suspended | Recessed | Recessed | Recessed | Recessed |
| Absolute Luminous Flux (up to) | 1155lm, 1548lm, 3587lm, 4767lm | 840lm, 1792lm | 3587lm | 706lm, 1347lm, 3177lm | 635lm | 635lm |
| Beam Type | Standard, Elliptical | Wallwasher | Standard, Elliptical | Standard, Elliptical | Standard | Standard |
| Beam Angle | Narrow (22-30°), Medium (40-50°), Wide (60-70°) | 50° Asymmetrical | Narrow (22-30°), Medium (40-50°), Wide (60-70°) | Narrow (12-30°), Medium (30-45°), Wide (50-60°) | Narrow (12°), Medium (30°), Wide (50°) | Narrow (12°), Medium (30°), Wide (50°) |
| Beam Angle (Elliptical) | Narrow (20x60°), Medium (30x70°), Wide (50x80°) | - | Narrow (20x60°), Medium (30x70°), Wide (50x80°) | Narrow (12x60°), Medium (35x70°), Wide (60x80°) | Narrow (12x60°), Medium (30x60°), Wide (40x70°) | Narrow (12x60°), Medium (30x60°), Wide (40x70°) |
| Illumination Type | Horizontal | Vertical | Horizontal | Horizontal | Horizontal | Horizontal / Vertical |
| CCT | 2700K, 3000K, 4000K, Tunable White (2700K - 6500K) | 2700K, 3000K, 4000K, Tunable White (2700K - 6500K) | 2700K, 3000K, 4000K, Tunable White (2700K - 6500K) | 2700K, 3000K, 4000K, Tunable White (2700K - 6500K) | 2700K, 3000K, 4000K, Tunable White (2700K - 6500K) | 2700K, 3000K, 4000K, Tunable White (2700K - 6500K) |
| UGR | <13 | <16 | <13 | <10 | <10 | <10 |
| Colour Deviation | ≤2 | ≤2 | ≤2 | ≤2 | ≤2 | ≤2 |
| Lifetime | >55,000h L90B10 | >55,000h L90B10 | >55,000h L90B10 | >55,000h L90B10 | >55,000h L90B10 | >55,000h L90B10 |
| IP Rating | IP54 | IP54 | IP65 | IP54 | IP54 | IP54 |
| IK Rating | - | - | IK10 | - | - | - |
| Driver | Phase-cut, Non-Dim, DALI, Bluetooth | Phase-cut, DALI, Bluetooth | Phase-cut, DALI, Bluetooth | Phase-cut, DALI, Bluetooth | Phase-cut, DALI, Bluetooth | Phase-cut, DALI, Bluetooth |
| Warranty | 5 Years | 5 Years | 5 Years | 5 Years | 5 Years | 5 Years |
| Availability | Stocked | Assembled | Made to Order | Stocked | Assembled | Assembled |
| Adjustability | - | - | - | 355° Rotation, 25° Tilt | - | Pivot on an axis & rotates |

Models



ION R Downlight



ION R Wallwasher



ION R Vandal-proof Downlight



ION R Adjustable Downlight



ION R Focus Downlight



ION R Accent Downlight

Sizes



Small (89mm)



Medium (103mm)



Large (142mm, 180mm)



XL (225mm)

Mounting



White Recessed Trim



Black Recessed Trim



White Surface Mounted Canister



Black Surface Mounted Canister



White Suspended Canister



Black Suspended Canister

Primary Optics



Pencil Lens (12°)



Narrow Lens (22°, 30°)



Medium Lens (40°, 50°)



Wide Lens (60°, 70°)

Secondary Optics



Elliptical Lens



Honeycomb Lens



Softening Lens



Anti-Glare Louvre

Baffles



Matt White Baffle



Matt Black Baffle



Gold Baffle



Stealth Metallic Baffle

A modular future of lighting

With modularity at the engineering forefront, the ION R Series fulfils our vision of creating a universal lighting solution encompassing various downlighting capabilities. This approach makes the luminaire highly customisable while simplifying installation and maintenance, ensuring consistent performance for years to come.



① Baffle

Allows further visual customisation with a wide range of baffle finishes. The Stealth Metallic baffle option, specifically, delivers an almost darklight effect, even when operating at high power.

② Secondary Optic

Add an additional layer of optical control opting for an additional softening, honeycomb or elliptical optic.

③ IP54 Seal

Allows the ION R downlight range to operate at IP54, ensuring protection against water splashes and security against dust for the downlight range.

④ Primary Optic

Designed from the ground up, the ION R Series' lens technology has been precisely engineered to perfectly align with the COB LED, delivering outstanding beam control with minimal light spillage.

⑤ Engine

Available in fixed and adjustable versions, the ION R's aluminium engine comes with heat-syncing ability to handle operation heat and promote passive airflow, ensuring quality and performance for a long time.

⑥ Trim

The trim is designed to support easy assembly and modularity with the engine.

Lighting simplified



Designed to support quick installation and interchangeability between models using the same engine, the ION R Series marks Unios' next step to making lighting more simple, fuss-free and easier for everyone.

Interchangeability

Redefine versatility with the ION R Series, where models using the same engine can interchange seamlessly between mounting options and across models.

Clip system

The ION R trim is equipped with built-in clips to secure the luminaire in recessed applications. Control of the clips' movements is done by the click of a button, making the process toolless and simple while preventing ceiling damage.

Quick installation

The ION R's ball-bearing system reduces installation friction, allowing the engine to click into the trim seamlessly. Having both the ball-bearing and the clip system built into the trim, the ION R Series offers significantly reduced installation time, thanks to its simple and hassle-free setup.



Lighting without boundaries



ION R Downlight

Available in Small, Medium, Large and XL

Delivers output from 9W-43W

Interchangeable between 3 mounting options

Compatible with honeycomb and linear secondary optics

Ideal for illuminating projects of all sizes



ION R Adjustable Downlight

Available in Small, Medium and Large

Offers 355° rotation and 25° tilt for directional flexibility

Compatible with honeycomb and linear secondary optics

Ideal for highlighting decors and illuminating spaces with vaulted, pitched or raked ceilings

Deeply recess the luminaire into the ceiling to reduce glare further

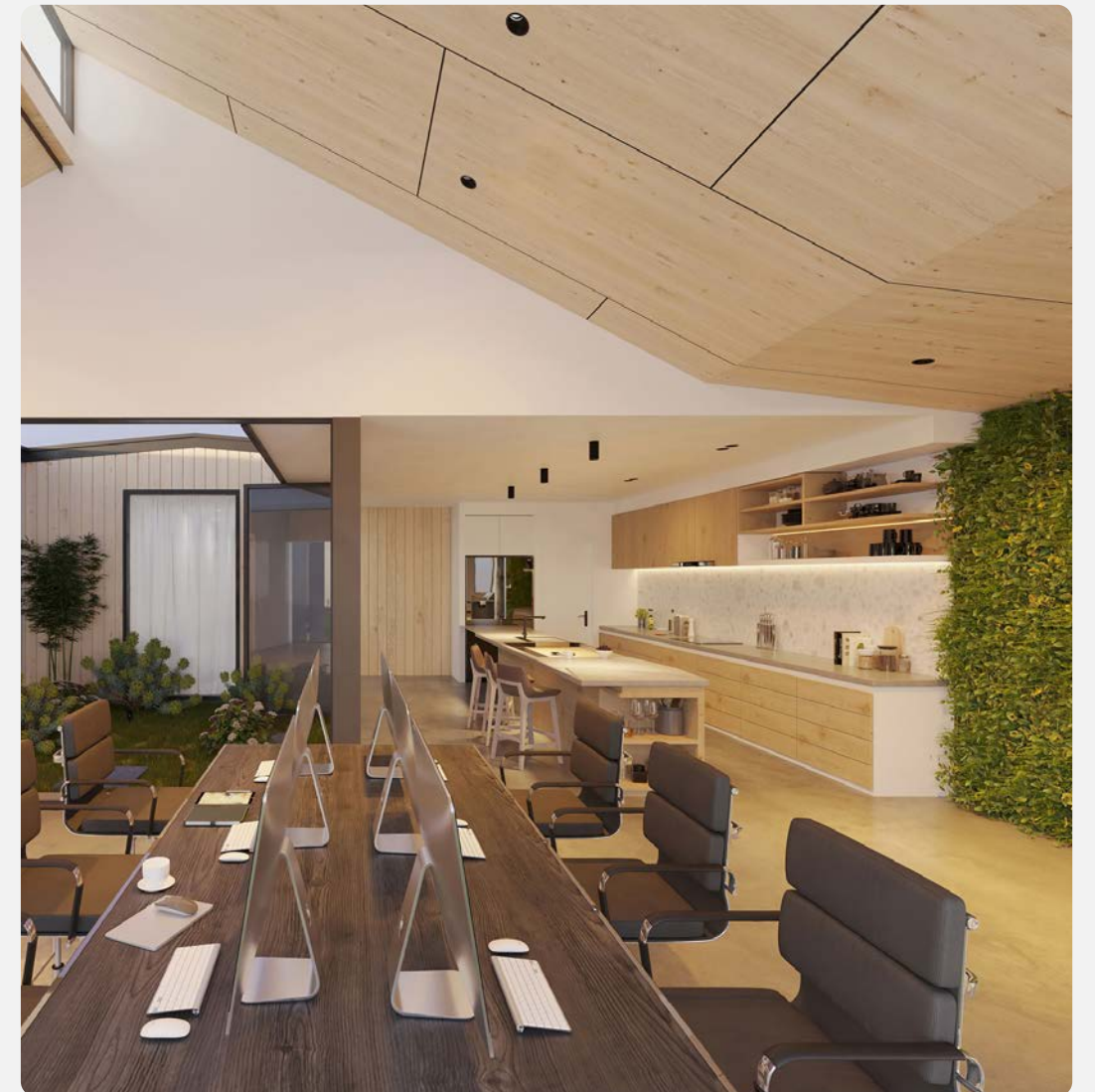

Configurable in a variety of models, sizes and power options, the ION R Series explores a new horizon of lighting adaptation.

From horizontal to vertical. Indoor to outdoor.

Offering a Wallwasher and a Vandal-proof model, the ION R Series caters to not only general and vertical illumination but also outdoor lighting, making it a versatile solution for your lighting requirements.



ION R Wallwasher

Available in Medium and Large sizes for different wall sizes

Available in recessed, surface mounted and suspended mounting option

Allows uniform illumination on walls and vertical surfaces

Pair with other ION R's models to achieve consistent aesthetics throughout your project

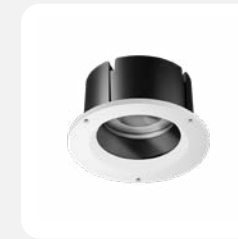

ION R Vandal-Proof Downlight

Available in Large size

Compatible with honeycomb and linear secondary optics

Direct mount the luminaire into the ceiling using tamper-proof screws to prevent vandalism

Comes in IK10, the highest standard of impact resistance

Designed in IP65, suitable for commercial-grade outdoor environments

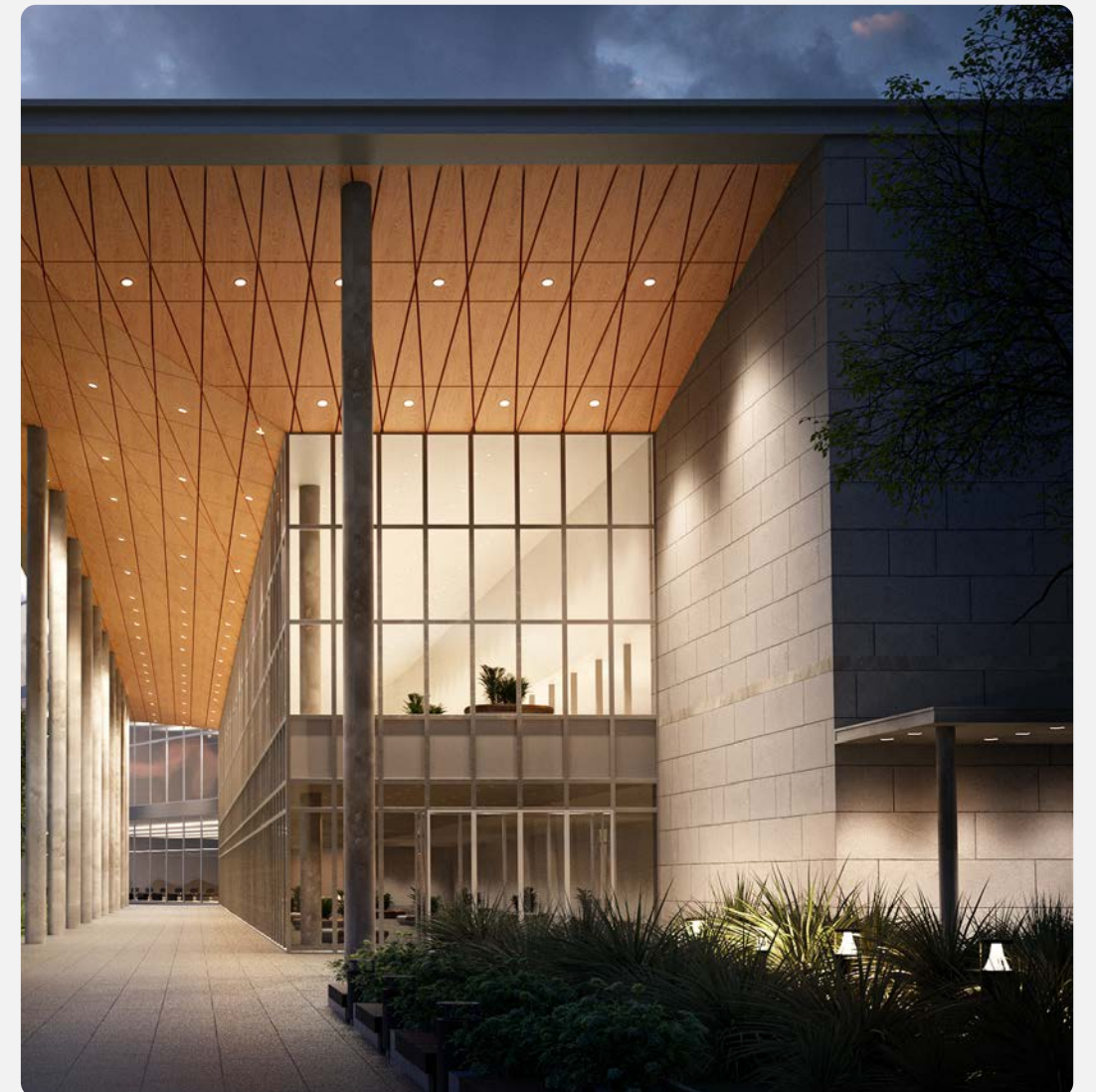

Highlight your objects of interest with perfection

The ION R Accent and Focus models blend seamlessly into the ceiling while providing precise illumination to accentuate your favourite objects and decors.



ION R Focus Downlight

Available in Small size

Conceal the light source with extremely low glare

Focus light on the area of interest with minimal light spill

Ideal for spotlighting objects, or for applications needing a moody ambience



ION R Accent Downlight

Available in Small size

Comes with a key-slot design for directional control of the light

Up to 25° tilt and 355° rotation for complete lighting flexibility

Ideal for accenting objects and artworks

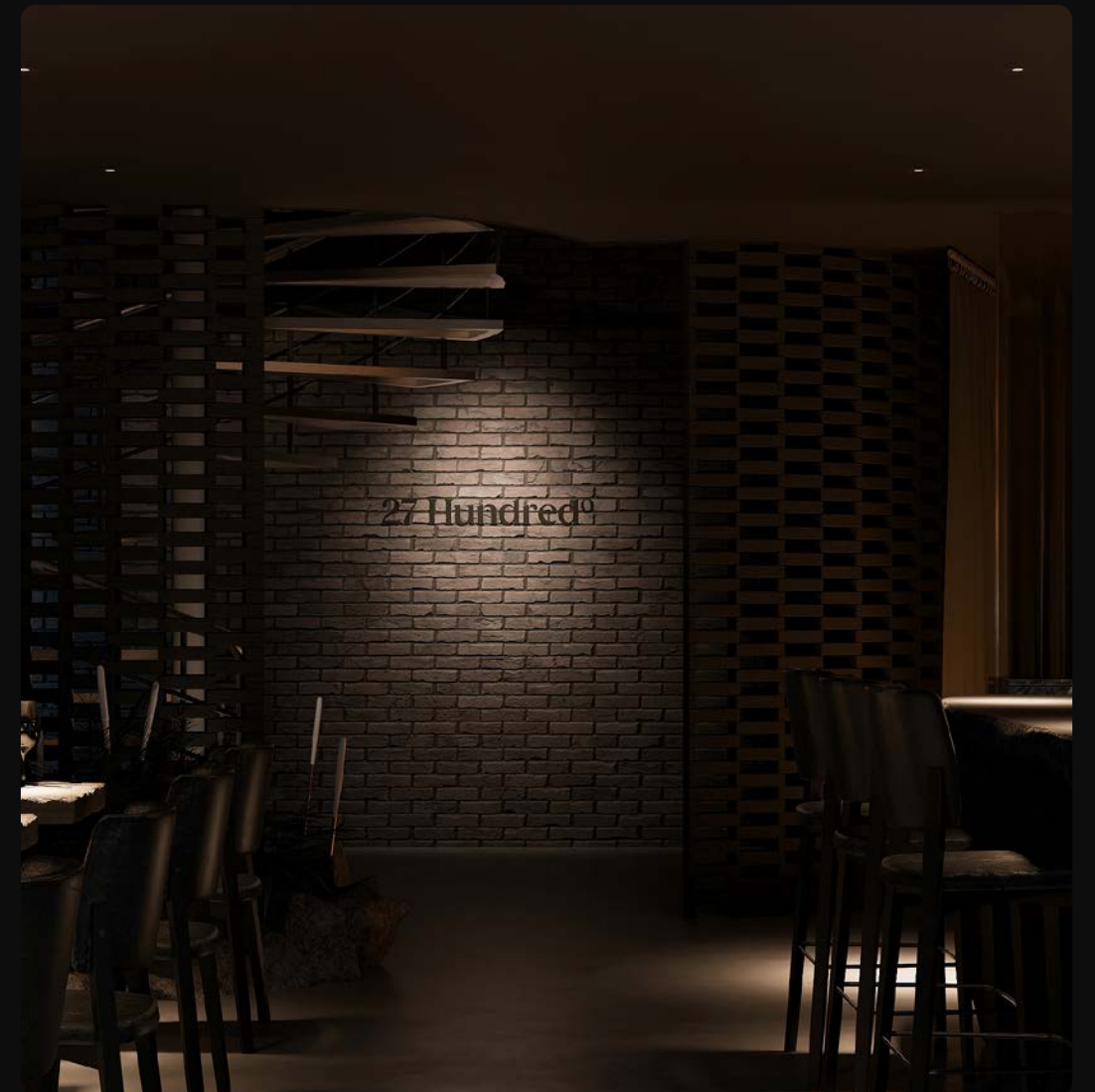



Stealth Metallic

Following the darklight concept, the Stealth Metallic baffle minimises the light source's presence. From certain angles, the light source is completely hidden from the peripheral vision, offering maximum visual comfort without sacrificing the output.

Designed with an outstanding optical performance

The ION R Series' primary optic is meticulously designed using lens technology, effectively delivering precise beam control and minimal light spillage.

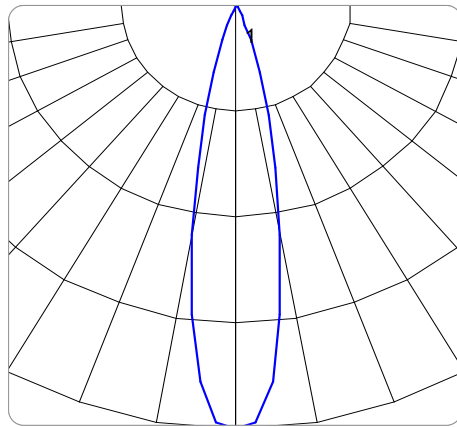
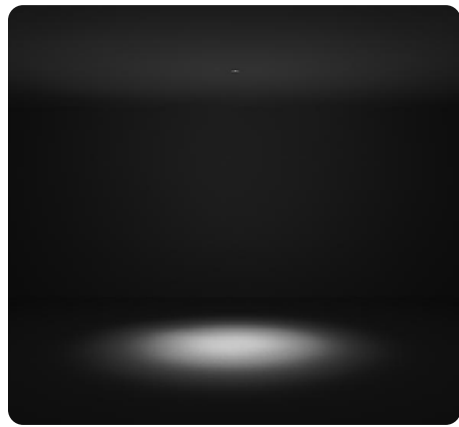

Narrow Beam Distribution

This beam distribution has been engineered to deliver high output and minimal light spill within its 22° beam angle, resulting in the optimum performance within the intended beam angle.

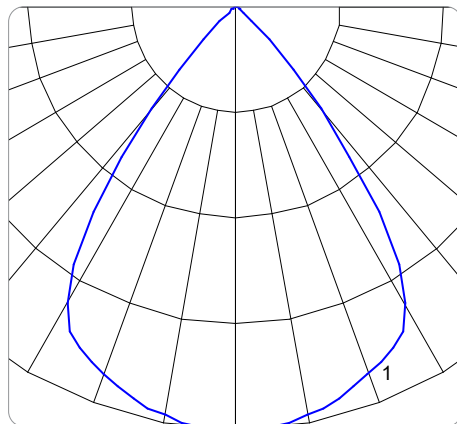
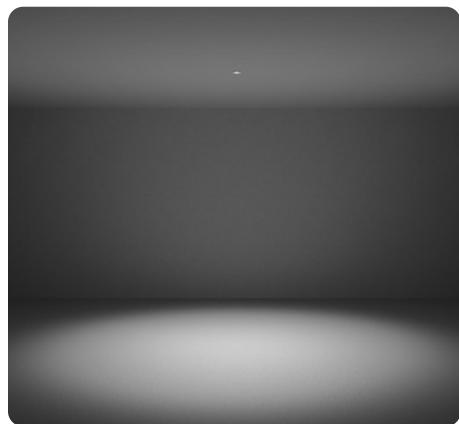

Wide Beam Distribution

Using lens technology, the ION R provides an evenly spread light intensity from the centre to the edge of the beam angle to achieve an umbrella-like distribution, where the illumination is consistent and uniform across the lit surface.

Anti-glare louvre

Comes with the Small and Medium sizes of the Standard model, the anti-glare louvre adds an extra level of glare reduction, allowing better beam control without sacrificing the luminaire's performance.



One engine. Multiple beam options.

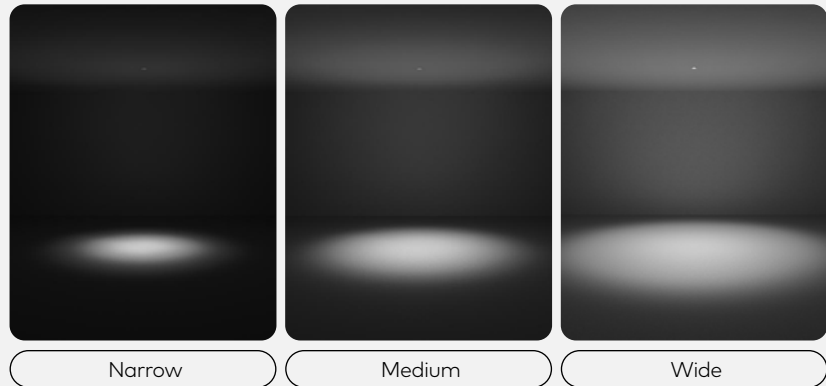

Symmetrical

With lens technology, the ION R Series can achieve outstanding beam control with minimum light spillage, ensuring the light sits within the intended area.

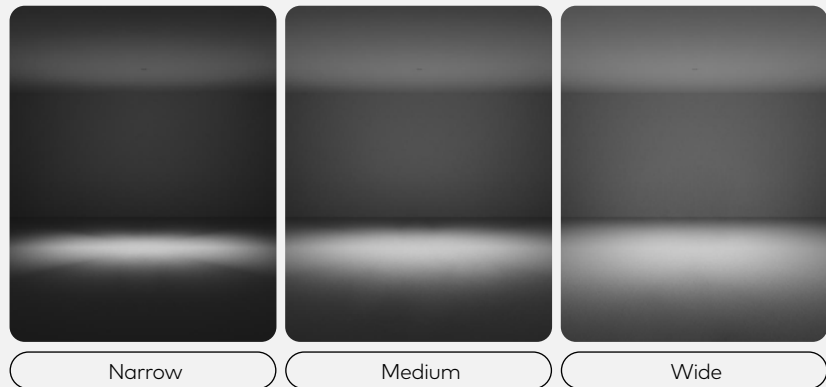

Elliptical

When paired with the Elliptical secondary optic, the ION R Series delivers an elliptical light distribution, ideal for lighting elongated surfaces that typically require two symmetrical beam outputs.

The ION R Series comes with an extensive range of secondary optics and accessories. See the images below to explore the ION R's beam output options.

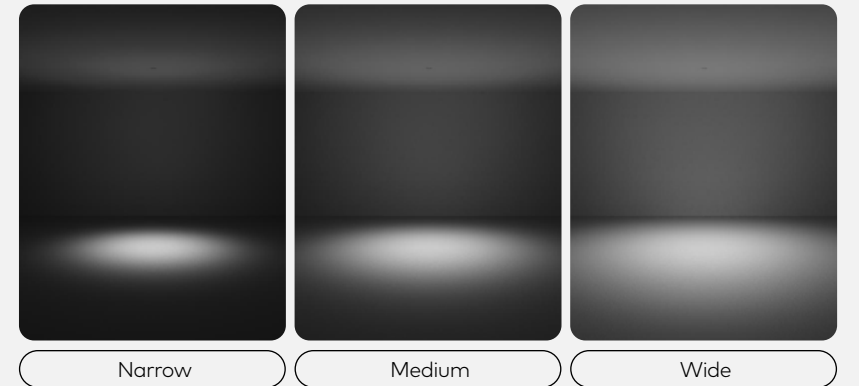

Soften

The softening secondary optic softens the light within the beam and at the edges to achieve a smooth and even lit surface. This beam option is ideal for spaces where uniform lighting is intended.

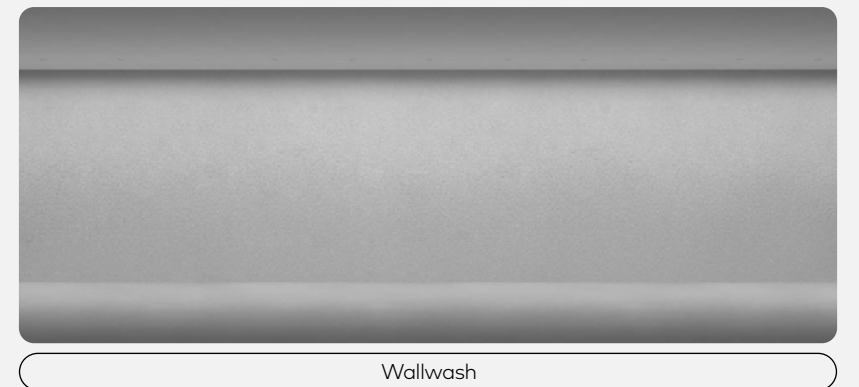

Wallwasher

Pair the ION R engine with the Wallwasher accessory to achieve a stunning wallwashing effect along walls that has the utmost uniformity.



The downlight range with unmatched performance

Meticulously designed for optimum performance, the ION R Series offers industry-leading colour consistency, tunable-white technology and compatibility with a range of drivers and Bluetooth services.

3000K

2500K

1800K

Tunable White

Set up the colour temperature to automatically change between 2700K to 6500K throughout the day to support the natural circadian rhythm.

IP54

Able to withstand light water splashing, suitable for both residential and commercial wet areas.

SDCM \leq 2

Meets the industry's highest colour accuracy standard in LED lighting for assured colour consistency over the product's operational lifetime.

L90B10

Lifetime up to >55,000h, ensuring the specified luminaire's performance is consistent until the end of the service life.

Driver

Compatible with Flicker-free, Bluetooth, Phase-cut and DALI drivers for optimum lighting control.

Bluetooth

Allows Bluetooth Smart Lighting integration with Casambi, which is easy to set up and offers customisable mobile settings.

UGR <13

A consistent UGR<13 across the series, which can be further reduced with additional accessories.

Seismic-resistant

Engine specifically designed with mounting points that can be opted for applications requiring seismic resistance.

One series. One project. Numerous applications.

With its high customisation, varied accessories and optics, there are various ways the downlight range can be installed in a project.



① Recessed

The recessed options are a true all-rounder, effortlessly blending into environments while providing class-leading performance.



② Surface Mounted

Surface mounted options provide a practical and aesthetically pleasing alternative in contexts such as between ceiling slats.



③ Suspended

Utilise suspended pendants to create visual interest and bring the source of light closer to table surfaces for a beautiful pin spot effect.



④ Wallwasher

Achieve a completely uniform wallwashing effect with accessories to illuminate verticals and reduce contrast in solutions.

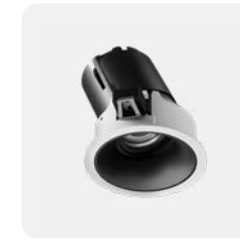

⑤ Adjustable

The ION R Adjustable is the ideal solution for highlighting objects of interest, thanks to its flexible directional lighting control and excellent optical performance.



⑥ External

The Vandal-proof option is engineered to be IP65 for easy commercial maintenance and IK10 to provide durability in a range of outdoor applications.

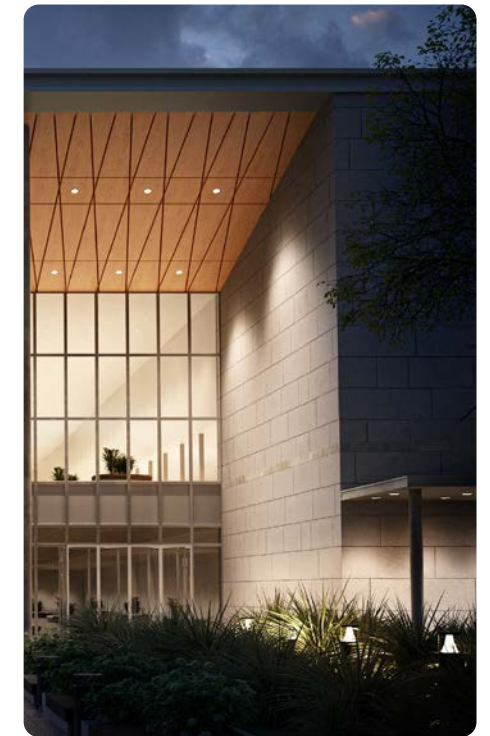

The one holistic downlight collection to save time

See the example of an office project below to explore the many ways the ION R Series can be customised for area-specific lighting needs.

Lobby

In large scale environments such as building lobbies, ION R Suspended Downlights (XL) can be used in combination with smaller ION R Surface Mounted Downlights (M).

Office

Open-plan office environments can combine different mounting options and accessories to accommodate exposed ceilings and dropped ceilings while delivering excellent vertical illumination.

Reception

Beautiful reception environments can be created by combining wallwashing effects for featured walls with the potential for suspended pendants to add an additional lighting dimension.

Boardroom

Depending on application intent, meeting rooms and boardrooms can be designed with a range of sizing options and a stealth metallic baffle to maximise visual comfort in meeting environments.

Cafeteria

In break out spaces and cafeterias, dining tables can be paired with suspended pendants for pin spotting and recessed variations to create optimum general lighting for other seating and recreation.

Terrace

Create outdoor environments that balance form and function. The vandal proof model of ION R is IP65 rated and vandal resistant while offering excellent performance and optics.

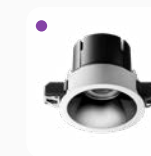

ION R Recessed Downlight

| | |
|---------------|--|
| Size | Medium |
| Mounting | Ceiling Recessed |
| Finish | <input type="checkbox"/> Textured White |
| Baffle Finish | <input checked="" type="checkbox"/> Stealth Metallic |

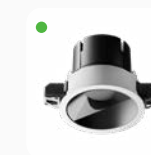

ION R Recessed Wallwasher

| | |
|---------------|---|
| Size | Medium |
| Mounting | Ceiling Recessed |
| Finish | <input type="checkbox"/> Textured White |
| Baffle Finish | <input type="checkbox"/> Matt White |

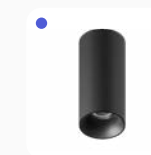

ION R Surface Mounted Downlight

| | |
|---------------|--|
| Size | Medium |
| Mounting | Ceiling Surface |
| Finish | <input checked="" type="checkbox"/> Textured Black |
| Baffle Finish | <input checked="" type="checkbox"/> Matt Black |

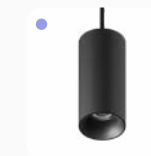

ION R Suspended Downlight

| | |
|---------------|--|
| Size | Medium |
| Mounting | Ceiling Suspended |
| Finish | <input checked="" type="checkbox"/> Textured Black |
| Baffle Finish | <input checked="" type="checkbox"/> Matt Black |



ION R Recessed Downlight

| | |
|---------------|---|
| Size | XL |
| Mounting | Ceiling Suspended |
| Finish | <input type="checkbox"/> Textured White |
| Baffle Finish | <input type="checkbox"/> Matt White |

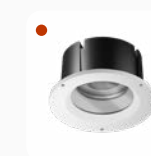

ION R Vandal-Proof Downlight

| | |
|---------------|---|
| Size | Large |
| Mounting | Ceiling Recessed |
| Finish | <input type="checkbox"/> Textured White |
| Baffle Finish | <input type="checkbox"/> Matt White |
| IP Rating | IP65 |

| | |
|--|-------|
| | 2700K |
| | 3000K |
| | 4000K |



ION R

Downlight



| | LED Power | Lumens (at 3000K) | Beam | Beam (Elliptical) | Weight | Driver Options | Lumen Efficacy |
|---------------------|--------------|-------------------|------------------|--------------------------|--------|----------------------------|----------------|
| 1 Small | 9W (250mA) | 963lm | 22° 40° 60° | 20x60° 30x70° 50x80° | 310g | Phase Cut, DALI, Bluetooth | Up to 93lm/W |
| | 11W (300mA) | 1155lm | | | | | |
| 2 Medium | 13W (350mA) | 1355lm | 22° 40° 60° | 20x60° 30x70° 50x80° | 456g | Phase Cut, DALI, Bluetooth | Up to 100lm/W |
| | 15W (400mA) | 1548lm | | | | | |
| | 22W (600mA) | 2392lm | 30° 50° 70° | 30x70° 50x80° 60x90° | 1108g | Phase Cut, DALI, Bluetooth | Up to 98lm/W |
| 3 Large | 27W (750mA) | 2990lm | | | | | |
| | 32W (900mA) | 3587lm | | | | | |
| | 36W (1000mA) | 3973lm | 30° 50° 70° | 30x70° 50x80° 60x90° | 1822g | Non-Dim, DALI, Bluetooth | Up to 105lm/W |
| 4 XL | 43W (1200mA) | 4767lm | | | | | |
| | 43W (1200mA) | 4767lm | | | | | |
| | 43W (1200mA) | 4767lm | | | | | |
| 5 Medium Wallwasher | 13W (350mA) | 760lm | 50° Asymmetrical | - | 456g | Phase Cut, DALI, Bluetooth | Up to 56lm/W |
| | 15W (400mA) | 868lm | | | | | |
| 6 Large Wallwasher | 22W (600mA) | 1194lm | 50° Asymmetrical | - | 1108g | Phase Cut, DALI, Bluetooth | Up to 49lm/W |
| | 27W (750mA) | 1493lm | | | | | |
| | 32W (900mA) | 1792lm | | | | | |

Key Information

| | |
|--------------------------------------|---|
| Mounting | Ceiling Recessed |
| Trim Finish | <input type="checkbox"/> Textured Black <input type="checkbox"/> Textured White <input type="checkbox"/> Matt Black <input type="checkbox"/> Matt White <input checked="" type="checkbox"/> Stealth Metallic <input type="checkbox"/> Matt Gold* |
| Baffle Finish | <input checked="" type="checkbox"/> Stealth Metallic <input type="checkbox"/> Matt Gold* |
| *Available in small and medium model | |
| Wallwasher Baffle Finish | <input checked="" type="checkbox"/> Stealth Metallic |
| LED CCT | <input type="checkbox"/> 2700K <input type="checkbox"/> 3000K <input type="checkbox"/> 4000K <input checked="" type="checkbox"/> 2700K-6500K (Tunable White) |
| Warranty | 5 Year |

Design

| | |
|-------------------|--|
| Product Family | ION |
| Material | Powder Coated Aluminium |
| IP Rating | IP54 (Room Side) |
| Class Rating | Class II |
| Insulation Rating | Small, Medium: IC-4 Large, XL: CA90 |

Performance

| | |
|-----------------------------------|-----------------|
| CRI (Ra/R9) | 92+ (R9: >50) |
| UGR | <13 |
| Lifetime (Ta 25°C) | >55,000h L90B10 |
| Ambient Temperature Range | -10°- 30°C |
| SDCM | ≤2 |
| COI Compliance model requirements | 4000K |

Driver

| | |
|-----------|--------|
| Non-Dim | Remote |
| Phase Cut | Remote |
| DALI | Remote |
| Bluetooth | Remote |

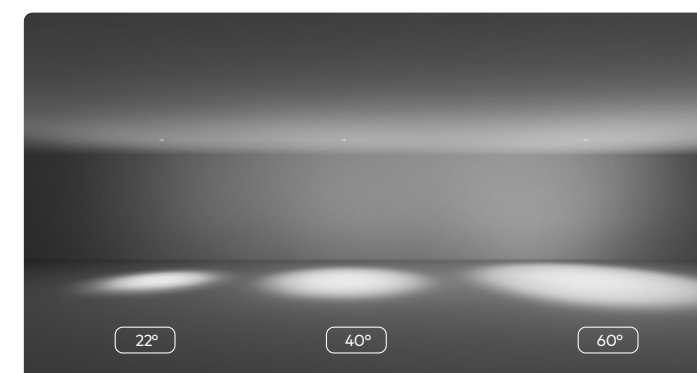

Available Accessories

| |
|---|
| Tension clips (for concrete applications, Medium size only) |
| Linear Lens (for elliptical beams) |
| Honeycomb Lens (for reduced glare) |
| Softening Lens (for softening beam edges) |
| Seismic Lanyard |

Notes

For 22° beam options, an anti-glare louvre is included to aid in beam control and glare (for small and medium only)



ION R

Surface Mounted Downlight



| | LED Power | Lumens (at 3000K) | Beam | Beam (Elliptical) | Weight | Driver Options | Lumen Efficacy |
|---------------------|--------------|-------------------|------------------|--------------------------|--------|----------------------------|----------------|
| 1 Small | 11W (300mA) | 1155lm | 22° 40° 60° | 20x60° 30x70° 50x80° | 714g | Phase Cut, DALI, Bluetooth | Up to 93lm/W |
| 2 Medium | 15W (400mA) | 1548lm | 22° 40° 60° | 20x60° 30x70° 50x80° | 955g | Phase Cut, DALI, Bluetooth | Up to 100lm/W |
| 3 Large | 32W (900mA) | 3587lm | 30° 50° 70° | 30x70° 50x80° 60x90° | 2278g | Phase Cut, DALI, Bluetooth | Up to 98lm/W |
| 4 XL | 43W (1200mA) | 4767lm | 30° 50° 70° | 30x70° 50x80° 60x90° | 3550g | Non-Dim, DALI, Bluetooth | Up to 105lm/W |
| 5 Medium Wallwasher | 15W (400mA) | 868lm | 50° Asymmetrical | - | 955g | Phase Cut, DALI, Bluetooth | Up to 56lm/W |
| 6 Large Wallwasher | 32W (900mA) | 1792lm | 50° Asymmetrical | - | 2278g | Phase Cut, DALI, Bluetooth | Up to 49lm/W |

| Key Information | | Design | | Performance | | Driver | |
|--------------------------------------|--|----------------|-------------------------|-----------------------------------|-----------------|-----------|----------|
| Mounting | Ceiling Surface | Product Family | ION | CRI (Ra/R9) | 92+ (R9: >50) | Non-Dim | Built-in |
| Canister Finish | <input type="checkbox"/> Textured Black <input type="checkbox"/> Textured White | Material | Powder Coated Aluminium | UGR | <13 | Phase Cut | Built-in |
| Baffle Finish | <input type="checkbox"/> Matt Black <input type="checkbox"/> Matt White <input type="checkbox"/> Stealth Metallic <input type="checkbox"/> Matt Gold* | IP Rating | IP44 | Lifetime (Ta 25°C) | >55,000h L90B10 | DALI | Built-in |
| | | Class Rating | Class I | Ambient Temperature Range | -10°- 30°C | Bluetooth | Remote |
| | | SDCM | ≤2 | COI Compliance model requirements | 4000K | | |
| *Available in small and medium model | | | | | | | |
| Wallwasher Baffle Finish | <input type="checkbox"/> Stealth Metallic | | | | | | |
| LED CCT | <input type="checkbox"/> 2700K <input type="checkbox"/> 3000K <input type="checkbox"/> 4000K <input type="checkbox"/> 2700K-6500K (Tunable White) | | | | | | |
| Warranty | 5 Year | | | | | | |

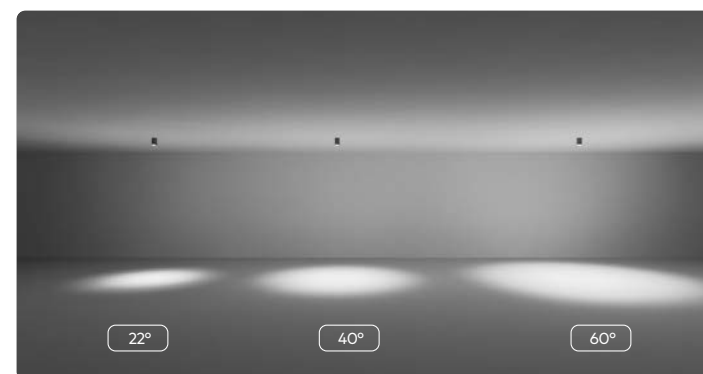

Available Accessories
 Linear Lens (for elliptical beams)
 Honeycomb Lens (for reduced glare)
 Softening Lens (for softening beam edges)

Notes
 For 22° beam options, an anti-glare louvre is included to aid in beam control and glare (for small and medium only)



ION R

Suspended Downlight

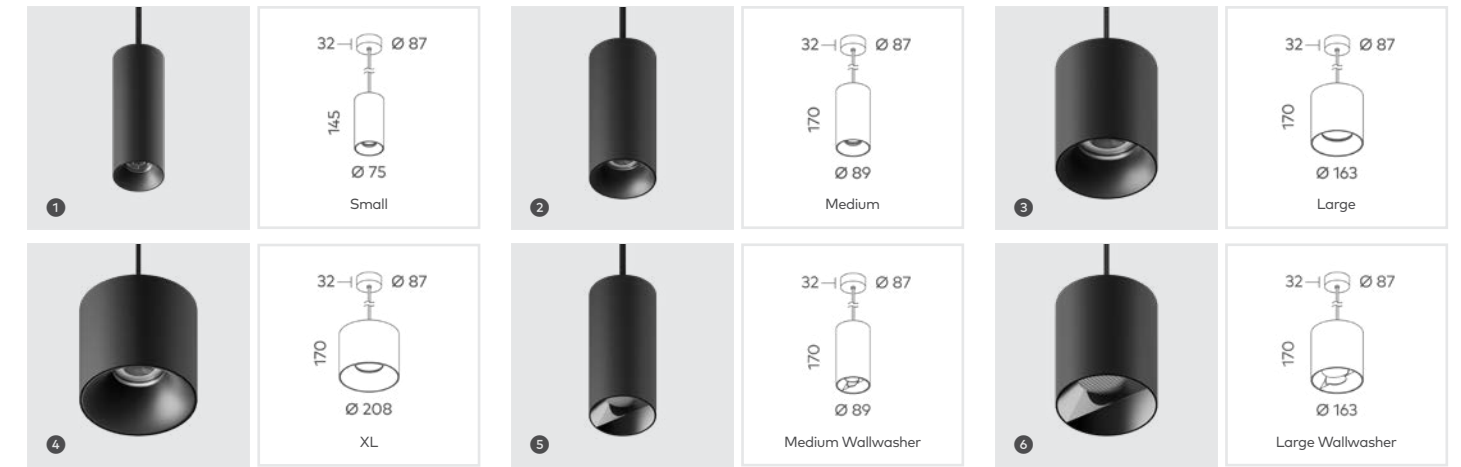

| | LED Power | Lumens (at 3000K) | Beam | Beam (Elliptical) | Weight | Driver Options | Lumen Efficacy |
|---------------------|--------------|-------------------|------------------|--------------------------|--------|----------------------------|----------------|
| 1 Small | 11W (300mA) | 1155lm | 22° 40° 60° | 20x60° 30x70° 50x80° | 1214g | Phase Cut, DALI, Bluetooth | Up to 93lm/W |
| 2 Medium | 15W (400mA) | 1548lm | 22° 40° 60° | 20x60° 30x70° 50x80° | 1455g | Phase Cut, DALI, Bluetooth | Up to 100lm/W |
| 3 Large | 32W (900mA) | 3587lm | 30° 50° 70° | 30x70° 50x80° 60x90° | 2778g | Phase Cut, DALI, Bluetooth | Up to 98lm/W |
| 4 XL | 43W (1200mA) | 4767lm | 30° 50° 70° | 30x70° 50x80° 60x90° | 4050g | Non-Dim, DALI, Bluetooth | Up to 105lm/W |
| 5 Medium Wallwasher | 15W (400mA) | 868lm | 50° Asymmetrical | - | 1455g | Phase Cut, DALI, Bluetooth | Up to 56lm/W |
| 6 Large Wallwasher | 32W (900mA) | 1792lm | 50° Asymmetrical | - | 2778g | Phase Cut, DALI, Bluetooth | Up to 49lm/W |

| Key Information | | Design | | Performance | | Driver | |
|--------------------------------------|--|----------------|-------------------------|-----------------------------------|-----------------|-----------|----------|
| Mounting | Ceiling Suspended | Product Family | ION | CRI (Ra/R9) | 92+ (R9: >50) | Non-Dim | Built-in |
| Canister Finish | <input type="checkbox"/> Textured Black <input type="checkbox"/> Textured White | Material | Powder Coated Aluminium | UGR | <13 | Phase Cut | Built-in |
| Baffle Finish | <input type="checkbox"/> Matt Black <input type="checkbox"/> Matt White <input type="checkbox"/> Stealth Metallic <input type="checkbox"/> Matt Gold* | IP Rating | IP20 | Lifetime (Ta 25°C) | >55,000h L90B10 | DALI | Built-in |
| | | Class Rating | Class I | Ambient Temperature Range | -10°- 30°C | Bluetooth | Remote |
| | | SDCM | ≤2 | COI Compliance model requirements | 4000K | | |
| *Available in small and medium model | | | | | | | |
| Wallwasher Baffle Finish | <input type="checkbox"/> Stealth Metallic | | | | | | |
| LED CCT | <input type="checkbox"/> 2700K <input type="checkbox"/> 3000K <input type="checkbox"/> 4000K <input type="checkbox"/> 2700K-6500K (Tunable White) | | | | | | |
| Warranty | 5 Year | | | | | | |

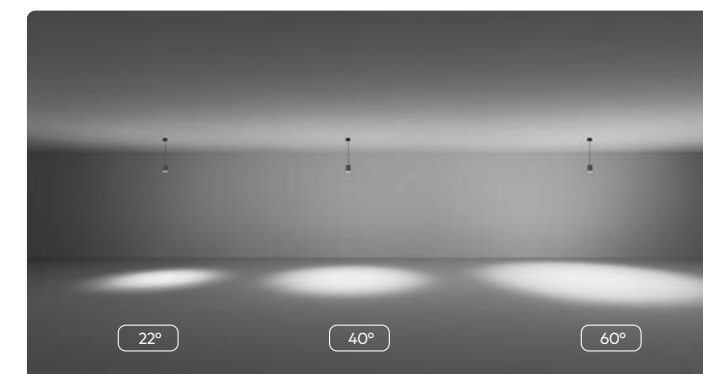

Available Accessories
 Linear Lens (for elliptical beams)
 Honeycomb Lens (for reduced glare)
 Softening Lens (for softening beam edges)

Notes
 For 22° beam options, an anti-glare louvre is included to aid in beam control and glare



ION R

Vandal-proof Downlight



| | LED Power | Lumens (at 3000K) | Beam | Weight |
|----------------|-------------|-------------------|-----------------|--------|
| 1 Vandal-proof | 22W (600mA) | 2391lm | 30° 50° 70° | 1356g |
| | 27W (750mA) | 2989lm | | |
| | 32W (900mA) | 3587lm | | |

| Key Information | | Design | | Performance | | Driver | |
|-----------------|--|-------------------|-------------------------|-----------------------------------|-----------------|-----------|--------|
| Mounting | Ceiling Recessed | Product Family | ION | Lumen efficacy | Up to 100lm/W | Phase Cut | Remote |
| Trim Finish | <input checked="" type="checkbox"/> Textured Black <input type="checkbox"/> Textured White | Material | Powder Coated Aluminium | CRI (Ra/R9) | 92+ (R9: >50) | DALI | Remote |
| Baffle Finish | <input checked="" type="checkbox"/> Matt Black <input type="checkbox"/> Matt White <input checked="" type="checkbox"/> Stealth Metallic | IP Rating | IP65 | UGR | <13 | Bluetooth | Remote |
| LED CCT | <input checked="" type="checkbox"/> 2700K <input type="checkbox"/> 3000K <input type="checkbox"/> 4000K <input checked="" type="checkbox"/> 2700K-6500K (Tunable White) | IK Rating | IK10 | Lifetime (Ta 25°C) | >55,000h L90B10 | | |
| Warranty | 5 Year | Class Rating | Class II | Ambient Temperature Range | -10°- 30°C | | |
| | | Insulation Rating | CA90 | SDCM | ≤2 | | |
| | | | | COI Compliance model requirements | 4000K | | |

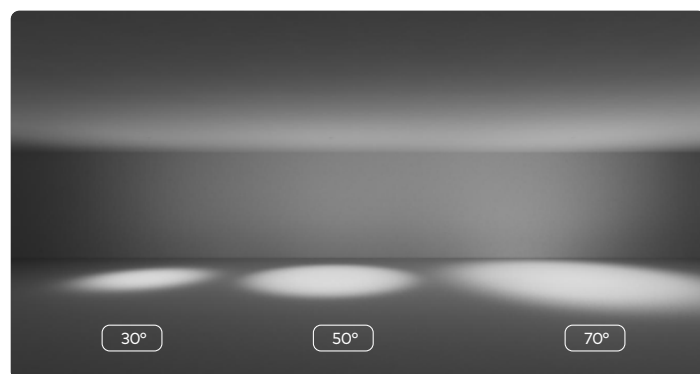

| Available Accessories |
|-----------------------|
| Seismic Lanyard |



ION R

Adjustable Downlight



| | LED Power | Lumens (at 3000K) | Beam | Beam (Elliptical) | Weight | Lumen Efficacy |
|----------|-------------|-------------------|-----------------|--------------------------|--------|----------------|
| 1 Small | 7W (200mA) | 659lm | 12° 30° 50° | 12x60° 30x60° 40x70° | 355g | Up to 72lm/W |
| 2 Medium | 9W (250mA) | 899lm | 22° 40° 60° | 20x60° 35x70° 50x70° | 600g | Up to 90lm/W |
| | 13W (350mA) | 1258lm | | | | |
| 3 Large | 22W (600mA) | 2237lm | 30° 45° 60° | 30x70° 45x60° 60x80° | 1310g | Up to 95lm/W |
| | 29W (800mA) | 2982lm | | | | |

| Key Information | | Design | | Performance | | Driver | |
|-----------------|---|-------------------|------------------------------------|-----------------------------------|-----------------|-----------|--------|
| Mounting | Ceiling Recessed | Product Family | ION | CRI (Ra/R9) | 92+ (R9: >50) | Non-Dim | Remote |
| Trim Finish | <input checked="" type="checkbox"/> Textured Black <input type="checkbox"/> Textured White | Adjustability | 355° Rotation 25° Tilt | UGR | <13 | Phase Cut | Remote |
| Baffle Finish | <input checked="" type="checkbox"/> Matt Black <input type="checkbox"/> Matt White <input checked="" type="checkbox"/> Stealth Metallic <input checked="" type="checkbox"/> Matt Gold* | Material | Powder Coated Aluminium | Lifetime (Ta 25°C) | >55,000h L90B10 | DALI | Remote |
| | <i>*Available in small and medium model</i> | IP Rating | IP54 (Room Side) | Ambient Temperature Range | -10°- 30°C | Bluetooth | Remote |
| LED CCT | <input checked="" type="checkbox"/> 2700K <input type="checkbox"/> 3000K <input type="checkbox"/> 4000K <input checked="" type="checkbox"/> 2700K-6500K (Tunable White) | Class Rating | Class II | SDCM | ≤2 | | |
| Warranty | 5 Year | Insulation Rating | Small, Medium: IC-4 Large: CA90 | COI Compliance model requirements | 4000K | | |

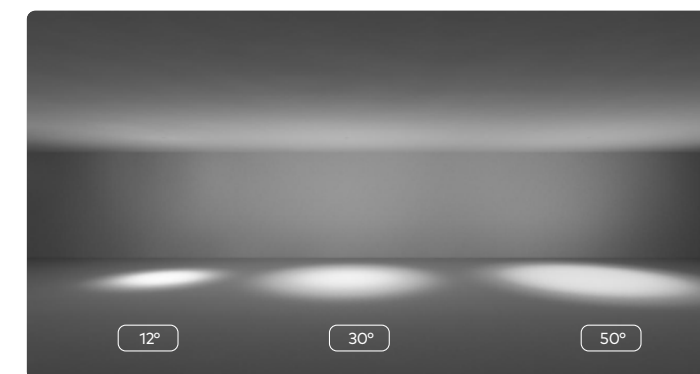

| Available Accessories |
|---|
| Linear Lens (for elliptical beams) |
| Honeycomb Lens (for reduced glare) |
| Softening Lens (for softening beam edges) |
| Seismic Lanyard |

| Notes |
|---|
| For 12° and 22° beam options, an anti-glare louvre is included to aid in beam control and glare (for small and medium only) |



ION R Focus

Downlight

ION R Accent

Downlight



| | LED Power | Lumens (at 3000K) | Beam | Beam (Elliptical) | Weight |
|---------|------------|-------------------|-----------------|--------------------------|--------|
| 1 Focus | 7W (200mA) | 593lm | 12° 30° 50° | 12x30° 30x60° 50x70° | 355g |

| | LED Power | Lumens (at 3000K) | Beam | Beam (Elliptical) | Weight |
|----------|------------|-------------------|-----------------|--------------------------|--------|
| 1 Accent | 7W (200mA) | 593lm | 12° 30° 50° | 12x30° 30x60° 50x70° | 355g |

| Key Information | | Design | | Performance | | Driver | |
|-----------------|--|-------------------|-------------------------|-----------------------------------|-----------------|-----------|--------|
| Mounting | Ceiling Recessed | Product Family | ION | Lumen efficacy | Up to 67lm/W | Non-Dim | Remote |
| Trim Finish | <input checked="" type="checkbox"/> Textured Black <input type="checkbox"/> Textured White | Material | Powder Coated Aluminium | CRI (Ra/R9) | 92+ (R9: >50) | Phase Cut | Remote |
| LED CCT | <input checked="" type="checkbox"/> 2700K <input type="checkbox"/> 3000K <input type="checkbox"/> 4000K <input checked="" type="checkbox"/> 2700K-6500K (Tunable White) | IP Rating | IP54 (Room Side) | UGR | <10 | DALI | Remote |
| Warranty | 5 Year | Class Rating | Class II | Lifetime (Ta 25°C) | >55,000h L90B10 | Bluetooth | Remote |
| | | Insulation Rating | IC-4 | Ambient Temperature Range | -10°- 30°C | | |
| | | | | SDCM | ≤2 | | |
| | | | | COI Compliance model requirements | 4000K | | |

| Key Information | | Design | | Performance | | Driver | |
|-----------------|--|-------------------|---------------------------|-----------------------------------|-----------------|-----------|--------|
| Mounting | Ceiling Recessed | Product Family | ION | Lumen efficacy | Up to 67lm/W | Non-Dim | Remote |
| Trim Finish | <input checked="" type="checkbox"/> Textured Black <input type="checkbox"/> Textured White | Adjustability | 355° Rotation 25° Tilt | CRI (Ra/R9) | 92+ (R9: >50) | Phase Cut | Remote |
| LED CCT | <input checked="" type="checkbox"/> 2700K <input type="checkbox"/> 3000K <input type="checkbox"/> 4000K <input checked="" type="checkbox"/> 2700K-6500K (Tunable White) | Material | Powder Coated Aluminium | UGR | <10 | DALI | Remote |
| Warranty | 5 Year | IP Rating | IP54 (Room Side) | Lifetime (Ta 25°C) | >55,000h L90B10 | Bluetooth | Remote |
| | | Class Rating | Class II | Ambient Temperature Range | -10°- 30°C | | |
| | | Insulation Rating | IC-4 | SDCM | ≤2 | | |
| | | | | COI Compliance model requirements | 4000K | | |

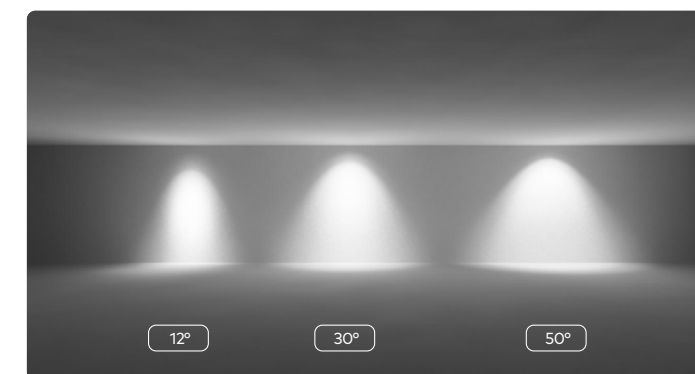
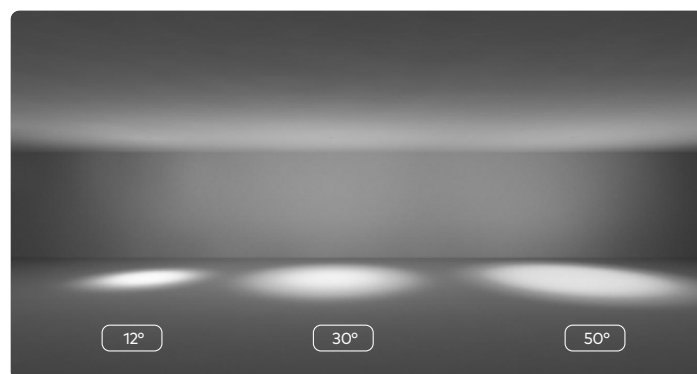

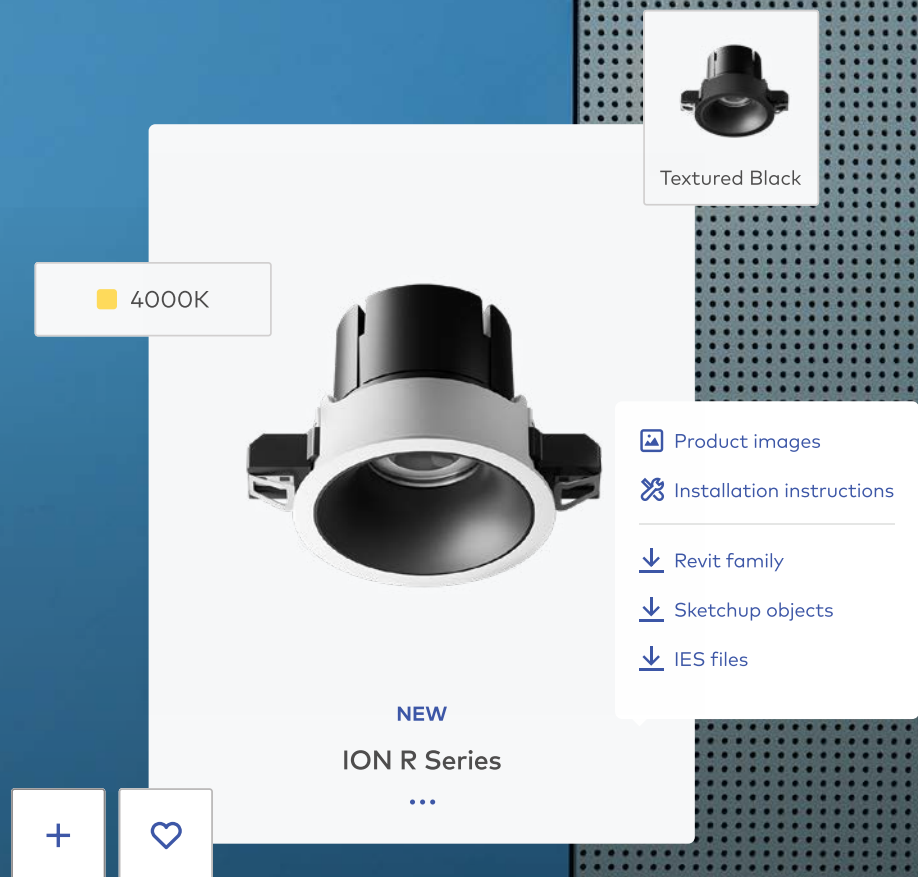

New Unios Toolbox & Website Experience

A new era of digital accessibility

Discover and be inspired by lighting in a whole new way

The new Unios Toolbox will provide a plethora of avenues to find the right lighting for your next project. You will have the tools to navigate products via project imagery, a robust filtering system or be served up smart alternative suggestions.

A new way to configure and manage lighting projects

The new product configurator will make lighting selection simpler than ever with a highly intuitive and live interface that caters to every type of user. Find the perfect product within a few clicks with accurate and live data.

The most complete lighting library at your fingertips

BIM objects, IES files, customised data sheets and product images are all easily accessible for your project requirements. All product variations are presented with a holistic view of each data point and piece of documentation you may require.

Special Thanks

This publication wouldn't be possible without the ongoing support of our project partners, distributors and photographers who have assisted in providing content.

More Information

For additional technical information and to access our full library, visit unios.com. Our library contains a comprehensive database of BIM objects, IES files and product imagery.

Instagram: @unioslight
Facebook: @unioslight
LinkedIn: @unios
YouTube: @unios
Pinterest: @unioslight

Published by
Unios Design

© Unios Pty Ltd 2023

No part of this catalogue may be reproduced without prior permission from Unios Pty Ltd. Models and technical specifications are subject to modification and enhancements.



Unios HQ (Australia)

T +61 8 9248 1888
E sales@unios.com
37 Boom Street,
Gnangara WA 6077

Sydney, Australia

T +61 8 9248 1888
E sydney@unios.com
103/13 Bowden Street,
Alexandria NSW 2015

Melbourne, Australia

T +61 8 9248 1888
E melbourne@unios.com
GF/ 341 George Street,
Fitzroy VIC 3065

Singapore

T +65 9040 3034
E singapore@unios.com
JustCo at 120 Robinson Road,
#15-01 Singapore 068913

Ho Chi Minh, Vietnam

T +84 28 3821 2927
E vietnam@unios.com
B2, tháp Canary, Đảo Kim
Cương, Quận 2, Hồ Chí Minh

Hanoi, Vietnam

T +84 28 3821 2927
E vietnam@unios.com
E2 - Chelsea Residence, 48 Trần Kim
Xuyến, Yên Hòa, Cầu Giấy, Hà Nội

Zhongshan, China

T +61 8 9248 1888
E china@unios.com
No.3 , FuTian 5 Road, Gangkou
District, Zhongshan City

Gyeonggido, South Korea

T +82 31 791 3922
E southkorea@unios.com
1038 Dadong, Hyundai Knowledge
Industry Center, 520 Misadaero, Hanamsi